

Especificaciones 4V100

SERIE	4V110-06	4V120-06	4V130C-06
FLUIDO	Aire Comprimido (filtrado a 40 micras)		
ACCIONAMIENTO	Internamente Piloteada		
TIPO DE VALVULA	5 vias 2 posiciones	5 vias 2 posiciones doble solenoide	5 vias 3 posiciones doble solenoide
PRESION DE OPERACION	21 a 114 psi (0.15 a .8 Mpa)		
CONEXION	1/8"		
Minima presion de trabajo	215 psi (1.5 bar)		
Temperatura	-20 a 70 °C		
Tiempo de Activacion	.05 seg. (y por debajo)		
Maxima frecuencia	10 ciclos/seg		
Consumo de Energia	AC 3.5 VA , DC 3.0 W		
Orificio	12 mm (CV=0.67)	9 mm (CV=0.5)	
PROTECCION	IP65 (DIN40050)		
VOLTAJES	12 VDC, 24 VDC, 24 VAC , 110 VAC, 220 VAC		
MATERIAL	Aleacion de Aluminio		

- 先导方式：外部与内部可选；
Pilot-oriented mode optional for internal or external;
- 滑柱式结构，密封性好，反应灵敏；
Structure in sliding column mode good tightness and sensitive reaction;
- 三位置电磁阀有三种中央功能可供选择；
Three position solenoid valves have three kinds of central function for your choice;
- 双头二位置电磁阀具有记忆功能；
Double control solenoid valves have memory function;
- 内孔采用特殊工艺加工，摩擦阻力小，启动气压低，使用寿命长；
Internal hole adopts special processing technology which has little attrition friction, low start pressure and long service life;
- 无需加油润滑；
No need to add oil for lubrication;
- 可与底座集成两组，节省安装空间；
It is available to form integrated valve group with the base to save installation space;
- 附设手动装置，利于安装调试；
Affiliated manual devices are equipped to facilitate installation and debugging;
- 有多种标准电压等级可供选用；
Several standard voltage grades are optional;



4V 1 10 - 06 - A - - -

型号 Type

4V 五口二位、五口三位电磁阀 Solenoid valve 5/2, 5/3 way

系列代号 Code

1 100 Series

电控方式 Valve type

10	双位置单电控 Single solenoid 5/2 way
20	双位置双电控 Double solenoid 5/2 way
30C	三位置双电控中位封闭型 Double solenoid 5/3 way closed center
30E	三位置双电控中位排气型 Double solenoid 5/3 way exhaust center
30P	三位置双电控中位压力型 Double solenoid 5/3 way pressure center

接管口径 Port size

M5	M5
06	1/8

标准电压 Voltage

A	AC220V
B	DC24V
C	AC110V
E	AC24V
F	DC12V

接口方式 Electrical entry

	DIN插座式 Terminal
I	出线式 Grommet

接口螺纹 Thread type

	PT
NPT	NPT
G	G

4V100 主要技术参数 General technical data				
型号 Type	4V110-M5	4V130C-M5	4V110-06	4V130C-06
	4V120-M5	4V130E-M5	4V120-06	4V130E-06
工作介质 Fluid	空气 (经40um滤芯过滤) Air(to be filtered by 40um filter element)			
动作方式 Acting	先导式 Internal piloted			
接管口径 Port size	进气=出气=M5 In=Out=M5		进气=出气=1/8 In=Out=1/8	
有效截面积 Orifice size	5.5mm ² (Cv=0.31)	5.0mm ² (Cv=0.28)	12.0mm ² (Cv=0.67)	9.0mm ² (Cv=0.50)
位置数 Valve type	五口二位 5 port 2 position	五口三位 5 port 3 position	五口二位 5 port 2 position	五口三位 5 port 3 position
使用压力范围 Operating pressure	0.15-0.8MPa(21-114Psi)			
保证耐压力 Proof pressure	1.5MPa(215Psi)			
工作温度 Temperature	-20-70℃			
本体材质 Material of body	铝合金 Aluminum alloy			
润滑 Lubrication	不需要 Not required			
最高动作频率 Max. frequency	5次/秒 5 cycle/sec	3次/秒 3 cycle/sec	5次/秒 5 cycle/sec	3次/秒 3 cycle/sec
重量 Weight	4V110-M5:120g 4V120-M5:175g	200g	4V110-06:120g 4V120-06:175g	200g
标准电压 Standard voltage	AC220V, AC110V, AC24V, DC24V, DC12V			
使用电压范围 Scope of voltage	AC: ±15%, DC: ±10%			
耗电量 Power consumption	AC:2.5VA, DC:2.5W			
保护等级 Protection	IP65(DIN40050)			
耐燃等级 Temperature classification	B级 B Class			
接口型式 Electrical entry	DIN 插座式, 出线式 Terminal, Grommet			
最短响应时间 Activating time	0.05秒 0.05 sec and below			

电磁阀 Solenoid valve / 4V100

技术参数 Technical data

电磁阀 Solenoid valve / 4V100

技术参数 Technical data

流量特性 Flow chart

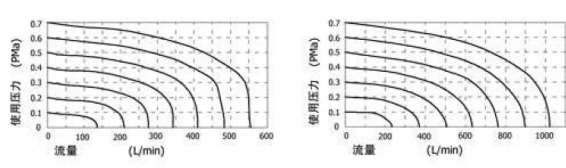

内部结构图 Inner structure

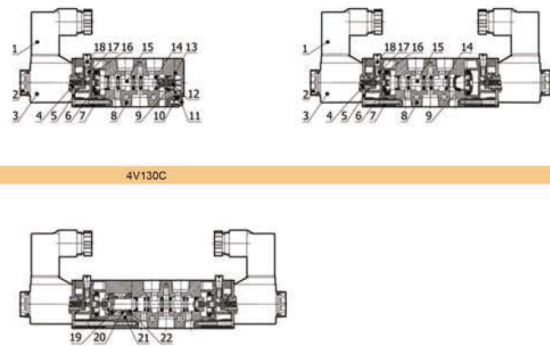

序号 NO.	名称 Item	序号 NO.	名称 Item
1	端子 Connector	12	弹簧 Spool spring
2	固定螺帽 Coil nut	13	止漏垫 Bottom cover gasket
3	线圈 Coil	14	O 令 Spool O-ring
4	可动铁 Armature	15	轴芯 Spool
5	固定铁片 Fixed plate	16	弹簧 O 令 Piston O-ring
6	活塞 Piston	17	弹簧 Override spring
7	引导本体 Pilot kit	18	手动销 Manual override
8	本体 Body	19	复位座 Spring holder
9	耐磨环 Wearing ring	20	弹簧 Return spring
10	底座 Bottom cover	21	侧盖 Side cover
11	螺钉 Fixed screw	22	复位座 Spring holder

尺寸图 Dimensions

型号 Model	A	B	C	D	E	F	G
4V110-M5	M5*0.8	27	14.7	0	14	21.2	0
4V110-06	PT1/8	28	14.2	1	16	20.2	3
4V120-M5	M5*0.8	27	57.2	0	14	64.3	0
4V120-06	PT1/8	28	57.2	1	16	63.2	3
4V130-M5	M5*0.8	27	57.7	0	14	64.3	0
4V130-06	PT1/8	28	57.2	1	16	63.2	3

4V110 DIN插座式(Terminal) 4V110 出线式(Grommet)

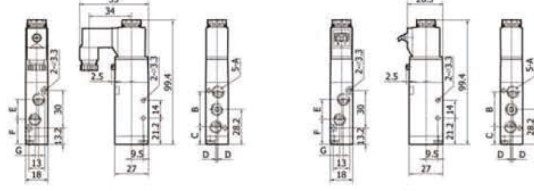

4V120 DIN插座式(Terminal) 4V120 出线式(Grommet)

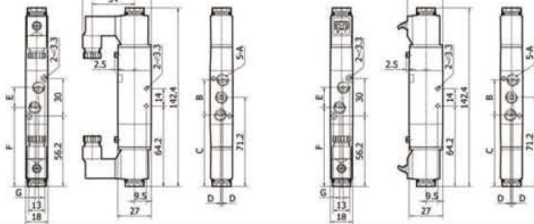

4V130 DIN插座式(Terminal) 4V130 出线式(Grommet)

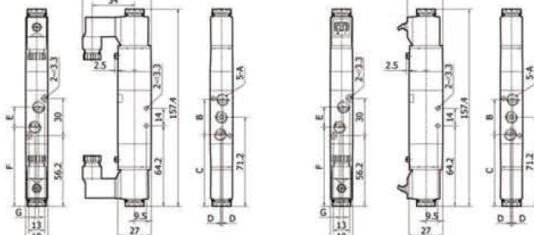

Especificaciones 4200

SERIE	4V210-06	4V220-06	4V230C-06	4V210-08	4V220-08	4V230C-08
FLUIDO	Aire Comprimido (filtrado a 40 micras)					
ACCIONAMIENTO	Internamente Piloteada					
TIPO DE VALVULA	5 vias 2 posiciones	5 vias 2 posiciones doble solenoide	5 vias 3 posiciones doble solenoide	5 vias 2 posiciones	5 vias 2 posiciones doble solenoide	5 vias 3 posiciones doble solenoide
PRESION DE OPERACION	21 a 114 psi (0.15 a .8 Mpa)					
CONEXION	1/8"	1/8"	1/8"	1/4"	1/4"	1/4"
Minima presion de trabajo	215 psi (1.5 bar)					
Temperatura	-20 a 70 °C					
Tiempo de Activacion	.05 seg. (y por debajo)					
Maxima frecuencia	5 ciclos/seg					
Consumo de Energia	AC 3.5 VA , DC 3.0 W					
Orificio	14 mm (CV=0.78)		12 mm (CV=0.67)	16 mm (CV=0.89)		12 mm (CV=0.67)
PROTECCION	IP65 (DIN40050)					
VOLTAJES	12 VDC, 24 VDC, 24 VAC , 110 VAC, 220 VAC					
MATERIAL	Aleacion de Aluminio					



1. 先导方式：外部与内部可选；
Pilot-oriented mode: optional for internal or external;
2. 薄柱式结构，密封性好，反应灵敏；
Structure in sliding column mode: good tightness and sensitive reaction;
3. 三位电磁阀有三种中央功能可供选择；
Three position solenoid valves have three kinds of central function for your choice;
4. 双头二位电磁阀具有记忆功能；
Double control solenoid valves have memory function;
5. 内孔采用特殊工艺加工，摩擦阻力小，启动气压低，使用寿命长；
Internal hole adopts special processing technology which has little attrition friction, low start pressure and long service life;
6. 无需加润滑油；
No need to add oil for lubrication;
7. 可与底座集成按钮，节省安装空间；
It is available to form integrated valve group with the base to save installation space;
8. 附设手动装置，利于安装调试；
Affiliated manual devices are equipped to facilitate installation and debugging;
9. 有多种标准电压等级可供选用；
Several standard voltage grades are optional;



4V 2 10 - 08 - A - - -

型号 Type

4V 五口二位、五口三位电磁阀 Solenoid valve 5/2、5/3way

系列代号 Code

2 200 Series

电控方式 Valve type

10 双位置单电控 Single solenoid 5/2 way

20 双位置双电控 Double solenoid 5/2 way

30C 三位置双电控中位封闭型
Double solenoid 5/3 way closed center

30E 三位置双电控中位排气型
Double solenoid 5/3 way exhaust center

30P 三位置双电控中位压力型
Double solenoid 5/3 way pressure center

接管口径 Port size

06 1/8

08 1/4

标准电压 Voltage

A AC220V

B DC24V

C AC110V

E AC24V

F DC12V

接电方式 Electrical entry

I DIN插座式 Terminal

II 出线式 Grommet

接管口螺纹 Thread type

PT

NPT

G

电磁阀 Solenoid valve / 4V200

流量特性 Flow chart

4V210-06

4V210-08

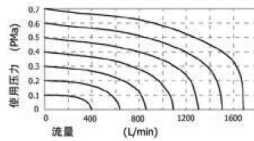
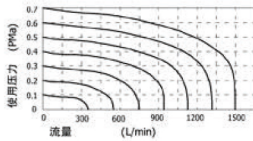

内部结构图 Inner structure

4V210

4V220

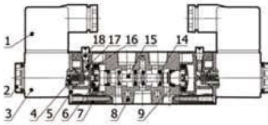
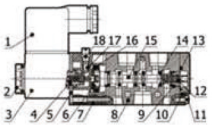

4V230C

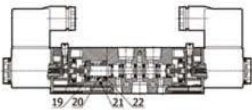

序号 NO.	名称 Item	序号 NO.	名称 Item
1	端子 Connector	12	弹簧 Spool spring
2	固定螺帽 Coil nut	13	止滑垫 Bottom cover gasket
3	线圈 Coil	14	O 令 Spool O-ring
4	可动铁 Armature	15	轴芯 Spool
5	固定铁片 Fixed plate	16	异型O令 Piston O-ring
6	活塞 Piston	17	弹簧 Override spring
7	引导本体 Pilot kit	18	手动销 Manual override
8	本体 Body	19	复位座 Spring holder
9	耐磨环 Wearing ring	20	弹簧 Return spring
10	底座 Bottom cover	21	侧盖 Side cover
11	螺钉 Fixed screw	22	复位座 Spring holder

4V200 主要技术参数 General technical data				
型号 Type	4V210-06	4V230C-06	4V210-08	4V230C-08
	4V220-06	4V230E-06	4V220-08	4V230E-08
工作介质 Fluid	空气 (经40um滤芯过滤) Air (to be filtered by 40um filter element)			
작동方式 Acting	先导式 Internal piloted			
接管口径 Port size	进气 = 出气 = 排气 = 1/8 In=Out=Exhaust=1/8		进气 = 出气 = 1/4, 排气 = 1/8 In=Out=1/4, Exhaust=1/8	
有效截面积 Orifice size	14.0mm ² (Cv=0.78)	12.0mm ² (Cv=0.67)	16.0mm ² (Cv=0.89)	12.0mm ² (Cv=0.67)
位置数 Valve type	五口二位 5 port 2 position	五口三位 5 port 3 position	五口二位 5 port 2 position	五口三位 5 port 3 position
使用压力范围 Operating pressure	0.15-0.8MPa(21-114PSi)			
保证耐压力 Proof pressure	1.5MPa(215PSi)			
工作温度 Temperature	-20-70℃			
本体材质 Material of body	铝合金 Aluminum alloy			
润滑 Lubrication	不需要 Not required			
最高动作频率 Max. frequency	5次/秒 5 cycle/sec	3次/秒 3 cycle/sec	5次/秒 5 cycle/sec	3次/秒 3 cycle/sec
重量 Weight	4V210-06:220g 4V220-06:320g	360g	4V210-08:220g 4V220-08:320g	360g
标准电压 Standard voltage	AC220V, AC110V, AC24V, DC24V, DC12V			
使用电压范围 Scope of voltage	AC: ±15%, DC: ±10%			
耗电量 Power consumption	AC:3.5VA, DC:3.0W			
保护等级 Protection	IP65(DIN40050)			
耐热等级 Temperature classification	B级 B Class			
接电型式 Electrical entry	DIN 插座式, 出线式 Terminal, Grommet			
最短励磁时间 Activating time	0.05秒 0.05 sec and below			

电磁阀 Solenoid valve / 4V200

尺寸图 Dimensions

型号 Model	A	B	C	D	E
4V210-06	PT1/8	PT1/8	18	22.7	0
4V210-08	PT1/8	PT1/4	21	21.2	3
4V220-06	PT1/8	PT1/8	18	76.4	0
4V220-08	PT1/8	PT1/4	21	74.9	3
4V230-06	PT1/8	PT1/8	18	76.4	0
4V230-08	PT1/8	PT1/4	21	74.9	3

4V210 DIN插座式(Terminal)

4V210 出线式(Grommet)

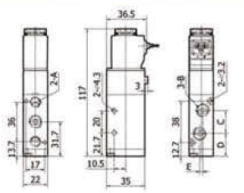
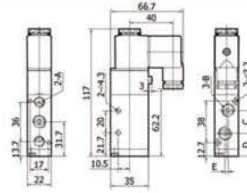

4V220 DIN插座式(Terminal)

4V220 出线式(Grommet)

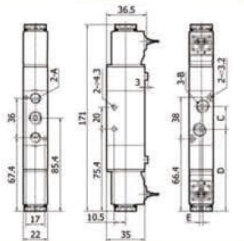
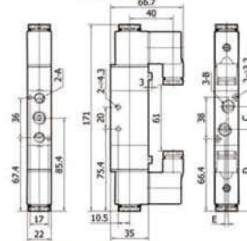

4V230 DIN插座式(Terminal)

4V230 出线式(Grommet)

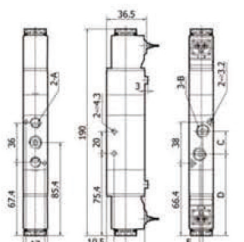
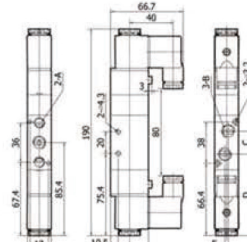

Especificaciones 4V300

SERIE	4V310-08	4V320-08	4V330C-08	4V310-10	4V320-10	4V330C-10
FLUIDO	Aire Comprimido (filtrado a 40 micras)					
ACCIONAMIENTO	Internamente Piloteada					
TIPO DE VALVULA	5 vias 2 posiciones	5 vias 2 posiciones doble solenoide	5 vias 3 posiciones doble solenoide	5 vias 2 posiciones	5 vias 2 posiciones doble solenoide	5 vias 3 posiciones doble solenoide
PRESION DE OPERACION	21 a 114 psi (0.15 a .8 Mpa)					
CONEXION	1/4"	1/4"	1/4"	3/8"	3/8"	3/8"
Mínima presión de trabajo	215 psi (1.5 bar)					
Temperatura	-20 a 70 °C					
Tiempo de Activación	.05 seg. (y por debajo)					
Máxima frecuencia	4 ciclos/seg					
Consumo de Energía	AC 3.5 VA , DC 3.0 W					
Orificio	25 mm (CV=1.40)		18 mm (CV=1.0)	30 mm (CV=1.68)		18 mm (CV=1.0)
PROTECCION	IP65 (DIN40050)					
VOLTAJES	12 VDC, 24 VDC, 24 VAC , 110 VAC, 220 VAC					
MATERIAL	Aleacion de Aluminio					

电磁阀 Solenoid valve / 4V300

型号代码 Type codes

1. 先导方式，外部与内部可选。
Pilot-oriented mode: optional for internal or external;
2. 滑柱式结构，密封性好，反应灵敏。
Structure in sliding column mode: good tightness and sensitive reaction;
3. 三位电磁阀有三种中央功能可供选择。
Three position solenoid valves have three kinds of central function for your choice;
4. 双头二位电磁阀具有记忆功能。
Double control solenoid valves have memory function;
5. 内孔采用特殊工艺加工，摩擦阻力小，启动气压低，使用寿命长。
Internal hole adopts special processing technology which has little attrition friction, low start pressure and long service life;
6. 充零加满润滑。
No need to add oil for lubrication;
7. 可与底座集成组，节省安装空间。
It is available to form integrated valve group with the base to save installation space.
8. 附设手动装置，利于安装调试。
Affiliated manual devices are equipped to facilitate installation and debugging;
9. 有多种标准电压等级可供选用。
Several standard voltage grades are optional;



4V 3 10 - 10 - A - -

型号 Type

4V 五口二位、五口三位电磁阀 Solenoid valve 5/2、5/3 way

系列代号 Code

3 300 Series

电控方式 Valve type

- 10 双位置单电控 Single solenoid 5/2 way
- 20 双位置双电控 Double solenoid 5/2 way
- 30C 三位置双电控中位封闭型
Double solenoid 5/3 way closed center
- 30E 三位置双电控中位排气型
Double solenoid 5/3 way exhaust center
- 30P 三位置双电控中位压力型
Double solenoid 5/3 way pressure center

接管口径 Port size

DB 1/4

10 3/8

标准电压 Voltage

- A AC220V
- B DC24V
- C AC110V
- E AC24V
- F DC12V

接电方式 Electrical entry

I DIN插座式 Terminal

l 出线式 Grommet

接管口螺牙 Thread type

PT

NPT NPT

G G

电磁阀 Solenoid valve / 4V300

技术参数 Technical data

电磁阀 Solenoid valve / 4V300

技术参数 Technical data

4V300 主要技术参数 General Technical data				
型号 Type	4V310-08	4V330C-08	4V310-10	4V330C-10
空气 (经40um滤芯过滤) Fluid Air (to be filtered by 40um filter element)	4V320-08	4V330E-08	4V320-10	4V330E-10
先导式 Internal piloted	4V330P-08		4V330P-10	
进气 = 排气 = 1/4 In=Out=Exhaust=1/4	进气 = 排气 = 3/8, 排气 = 1/4 In=Out=3/8, Exhaust=1/4			
有效截面积 Orifice size	25.0mm ² (Cv=1.40)	18.0mm ² (Cv=1.00)	30.0mm ² (Cv=1.68)	18.0mm ² (Cv=1.00)
位置数 Valve type	五口二位 5 port 2 position	五口三位 5 port 3 position	五口二位 5 port 2 position	五口三位 5 port 3 position
使用压力范围 Operating pressure	0.15~0.8MPa(21~114Psi)			
保证耐压力 Proof pressure	1.5MPa(215Psi)			
工作温度 Temperature	-20~70℃			
本体材质 Material of body	铝合金 Aluminum alloy			
润滑 Lubrication	不需要 Not required			
最高动作频率 Max. frequency	4次 / 秒 4 cycle/sec	3次 / 秒 3 cycle/sec	4次 / 秒 4 cycle/sec	3次 / 秒 3 cycle/sec
重量 Weight	4V310-08:310g 4V320-08:400g	450g	4V310-10:310g 4V320-10:400g	450g
标准电压 Standard voltage	AC220V, AC110V, AC24V, DC24V, DC12V			
使用电压范围 Scope of voltage	AC: ± 15%, DC: ± 10%			
耗电量 Power consumption	AC: 3.5VA, DC: 3.0W			
保护等级 Protection	IP65(DIN40050)			
耐热等级 Temperature classification	B级 B Class			
接电型式 Electrical entry	DIN 插座式, 出线式 Terminal, Grommet			
最短励磁时间 Activating time	0.05秒 0.05 sec and below			

Pneumatic component 45-46 Valves

电磁阀 Solenoid valve / 4V300

技术参数 Technical data

电磁阀 Solenoid valve / 4V300

技术参数 Technical data

电磁阀 Solenoid valve / 4V300

技术参数 Technical data

电磁阀 Solenoid valve / 4V300

技术参数 Technical data

流量特性 Flow chart

4V310-08

4V310-10

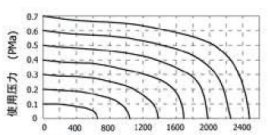
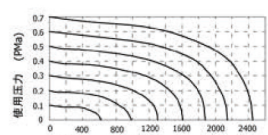

内部结构图 Inner structure

4V310

4V320

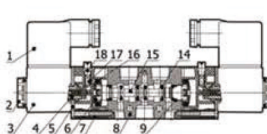
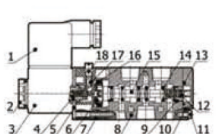

4V330C

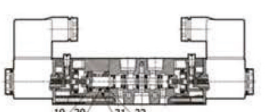

序号 NO.	名称 Item	序号 NO.	名称 Item
1	端子 Connector	12	弹簧 Spool spring
2	固定螺母 Coil nut	13	止逆垫 Bottom cover gasket
3	线圈 Coil	14	O 令 Spool O-ring
4	可动铁 Armature	15	轴芯 Spool
5	固定铁片 Fixed plate	16	异型O令 Piston O-ring
6	活塞 Piston	17	弹簧 Override spring
7	引导本体 Pilot kit	18	手动锁 Manual override
8	本体 Body	19	复位座 Spring holder
9	耐磨环 Wearing ring	20	弹簧 Return spring
10	底座 Bottom cover	21	侧盖 Side cover
11	螺钉 Fixed screw	22	复位座 Spring holder

尺寸图 Dimensions

型号 Model	A	B	C	D	E
4V310-08	PT1/4	PT1/4	22	29	0
4V310-10	PT1/4	PT3/8	24	28	4
4V320-08	PT1/4	PT1/4	22	83.9	0
4V320-10	PT1/4	PT3/8	24	82.9	4
4V330-08	PT1/4	PT1/4	22	83.9	0
4V330-10	PT1/4	PT3/8	24	82.9	4

4V310 DIN插座式(Terminal)

4V310 出线式(Grommet)

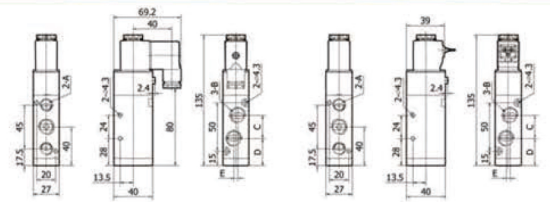

4V320 DIN插座式(Terminal)

4V320 出线式(Grommet)

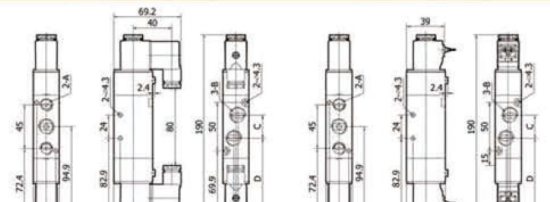

4V330 DIN插座式(Terminal)

4V330 出线式(Grommet)

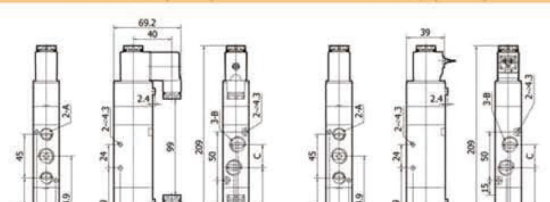

Especificaciones 4V400

SERIE	4V410-15	4V420-15	4V430C-15
FLUIDO	Aire Comprimido (filtrado a 40 micras)		
ACCIONAMIENTO	Internamente Piloteada		
TIPO DE VALVULA	5 vias 2 posiciones	5 vias 2 posiciones doble solenoide	5 vias 3 posiciones doble solenoide
PRESION DE OPERACION	21 a 114 psi (0.15 a .8 Mpa)		
CONEXION	Presion y Exhaust 1/2"		
Minima presion de trabajo	215 psi (1.5 bar)		
Temperatura	-20 a 70 °C		
Tiempo de Activacion	.05 seg. (y por debajo)		
Maxima frecuencia	3 ciclos/seg		
Consumo de Energia	AC 3.5 VA , DC 3.0 W		
Orificio	50 mm (CV=2.79)	30 mm (CV=1.68)	
PROTECCION	IP65 (DIN40050)		
VOLTAJES	12 VDC, 24 VDC, 24 VAC , 110 VAC, 220 VAC		
MATERIAL	Aleacion de Aluminio		

电磁阀 Solenoid valve / 4V400

型号代码 Type codes

FORWARD

电磁阀 Solenoid valve / 4V400

技术参数 Technical data

FORWARD

- 先导方式：外部与内部可选；
Pilot-oriented mode: optional for internal or external;
- 滑柱式结构，密封性好，反应灵敏；
Structure in sliding column mode good tightness and sensitive reaction;
- 三位电磁阀有三种中央功能可供选择；
Three position solenoid valves have three kinds of central function for your choice;
- 双头二位电磁阀具有记忆功能；
Double control solenoid valves have memory function;
- 内孔采用特殊工艺加工，磨擦阻力小，启动气压低，使用寿命长；
Internal hole adopts special processing technology which has little attrition friction, low start pressure and long service life;
- 无需加添润滑油；
No need to add oil for lubrication;
- 可与底座集成模组，节省安装空间；
It is available to form integrated valve group with the base to save installation space;
- 附设手动装置，利于安装调试；
Affiliated manual devices are equipped to facilitate installation and debugging;
- 有多种标准电压等级可供选用；
Several standard voltage grades are optional;

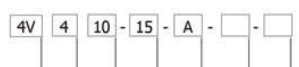

型号 Type	
4V	五口二位、五口三位电磁阀 Solenoid valve 5/2、5/3way
系列代号 Code	
4	400 Series
电控方式 Valve type	
10	双位置单电控 Single solenoid 5/2 way
20	双位置双电控 Double solenoid 5/2 way
30C	三位置双电控中位封闭型 Double solenoid 5/3 way closed center
30E	三位置双电控中位排气型 Double solenoid 5/3 way exhaust center
30P	三位置双电控中位压力型 Double solenoid 5/3 way pressure center
接管口径 Port size	
15	1/2
标准电压 Voltage	
A	AC220V
B	DC24V
C	AC110V
E	AC24V
F	DC12V
接线方式 Electrical entry	
T	DIN插座式 Terminal
G	出线式 Grommet
接管口螺纹 Thread type	
PT	PT
NPT	NPT
G	G

4V400 主要技术参数 General technical data					
型号 Type	4V410-15	4V420-15	4V430C-15	4V430E-15	4V430P-15
工作介质 Fluid	空气 (经40um滤芯过滤) Air (to be filtered by 40um filter element)				
动作方式 Acting	先导式 Internal piloted				
接管口径 Port size	进气 = 出气 = 排气 = 1/2 In=Out=Exhaust=1/2				
有效截面积 Orifice size	50.0mm ² (Cv=2.79)		30.0mm ² (Cv=1.68)		
位置数 Valve type	五口二位 5 port 2 position		五口三位 5 port 3 position		
使用压力范围 Operating pressure	0.15-0.8MPa(21-114Psi)				
保证耐压力 Proof pressure	1.5MPa(215Psi)				
工作温度 Temperature	-20-70℃				
本体材质 Material of body	铝合金 Aluminum alloy				
润滑 Lubrication	不需要 Not required				
最高动作频率 Max. Frequency	3次/秒 3 cycle/sec				
重量 Weight	590g	720g	770g		
标准电压 Standard voltage	AC220V, AC110V, AC24V, DC24V, DC12V				
使用电压范围 Scope of voltage	AC: ±15%, DC: ±10%				
耗电量 Power consumption	AC: 3.5VA, DC: 3.0W				
保护等级 Protection	IP65(DIN40050)				
耐热等级 Temperature classification	B级 B Class				
接线型式 Electrical entry	DIN 插座式, 出线式 Terminal, Grommet				
最短励磁时间 Activating time	0.05秒 0.05 sec and below				

Pneumatic component 49-50 Valves

电磁阀 Solenoid valve / 4V400

技术参数 Technical data

FORWARD

电磁阀 Solenoid valve / 4V400

技术参数 Technical data

FORWARD

流量特性 Flow chart 4V410-15

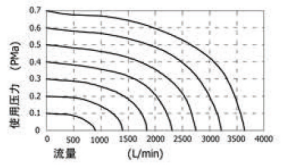

内部结构图 Inner structure 4V410 4V420

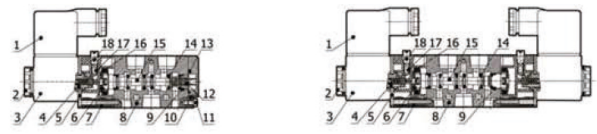

4V430C

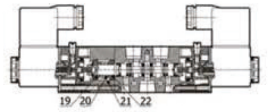

序号 NO.	名称 Item	序号 NO.	名称 Item
1	端子 Connector	12	弹簧 Spool spring
2	固定螺母 Coil nut	13	止泄垫 Bottom cover gasket
3	线圈 Coil	14	O 令 Spool O-ring
4	可动铁 Armature	15	轴芯 Spool
5	固定铁片 Fixed plate	16	异形O令 Piston O-ring
6	活塞 Piston	17	弹簧 Override spring
7	引导本体 Pilot kit	18	手动销 Manual override
8	本体 Body	19	复位座 Spring holder
9	耐磨环 Wearing ring	20	弹簧 Return spring
10	底盖 Bottom cover	21	侧盖 Side cover
11	螺钉 Fixed screw	22	复位座 Spring holder

尺寸图 Dimensions 4V410 DIN插座式(Terminal) 4V410 出线式(Grommet)

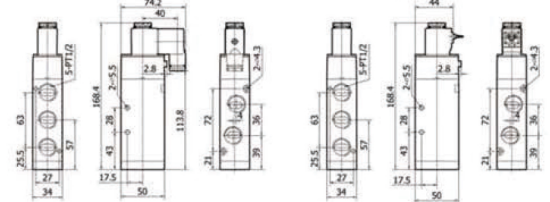

4V420 DIN插座式(Terminal) 4V420 出线式(Grommet)

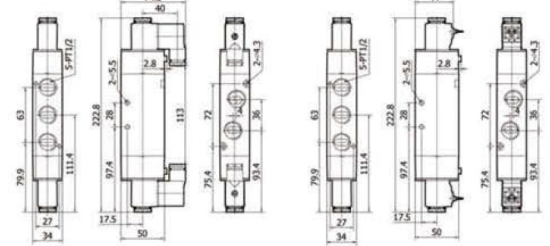

4V430 DIN插座式(Terminal) 4V430 出线式(Grommet)

